

- NOTES:**
1. MINIMUM COVER FROM FINISH GRADE TO TOP OF PIPE SHALL BE 2.5 FEET AND 3 FEET UNDER ROADWAYS, UNLESS NOTED OTHERWISE.
  2. MINIMUM SLOPE OF INSTALLED PIPING SHALL BE 0.003 FT/FT.
  3. LOT LINES AND RIGHT-OF-WAYS SHOWN ARE APPROXIMATE ONLY.
  4. IT IS ANTICIPATED THE TELEPHONE, POWER, CABLE T.V., WATER, AND SEWER THAT EXIST WITHIN THE STREET AND UTILITY CORRIDOR AND INDIVIDUALLY PROVIDE SERVICE TO EACH LOT WILL BE ENCOUNTERED DURING CONSTRUCTION. CONTRACTOR SHALL PLAN FOR CROSSING AND/OR EXCAVATING ALONG THESE UTILITIES AT EACH LOT AND/OR WITHIN THE STREET AND UTILITY CORRIDOR WITHOUT ADDITIONAL COMPENSATION.
  5. SERVICES LOCATED DOWNHILL OF MAIN LINE ARE TO DRAIN BACK TO MAIN LINE, UNLESS DESIGNATED "WITH DRAIN".

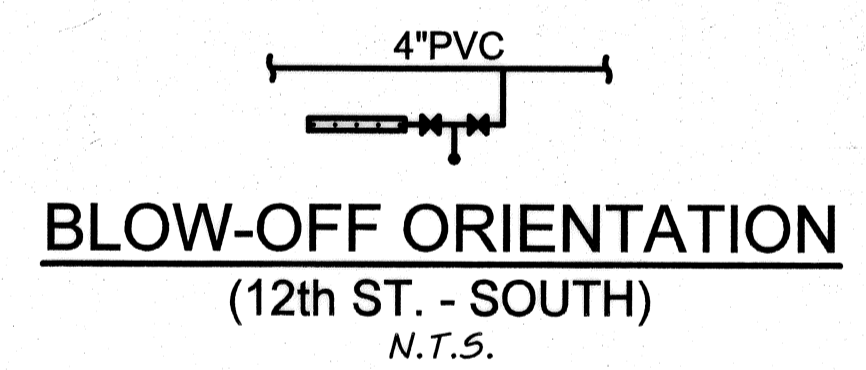
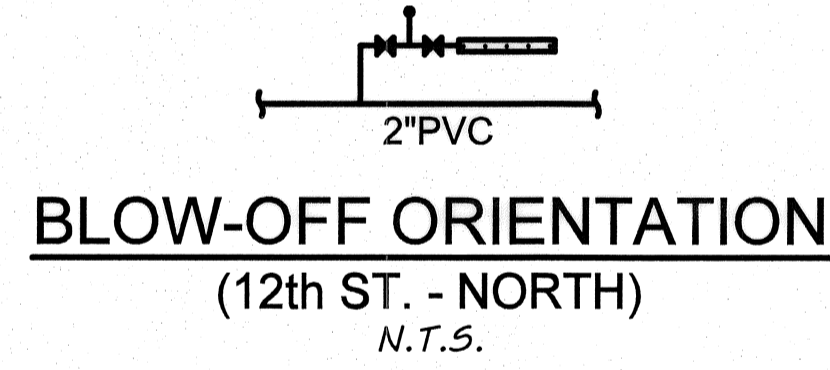
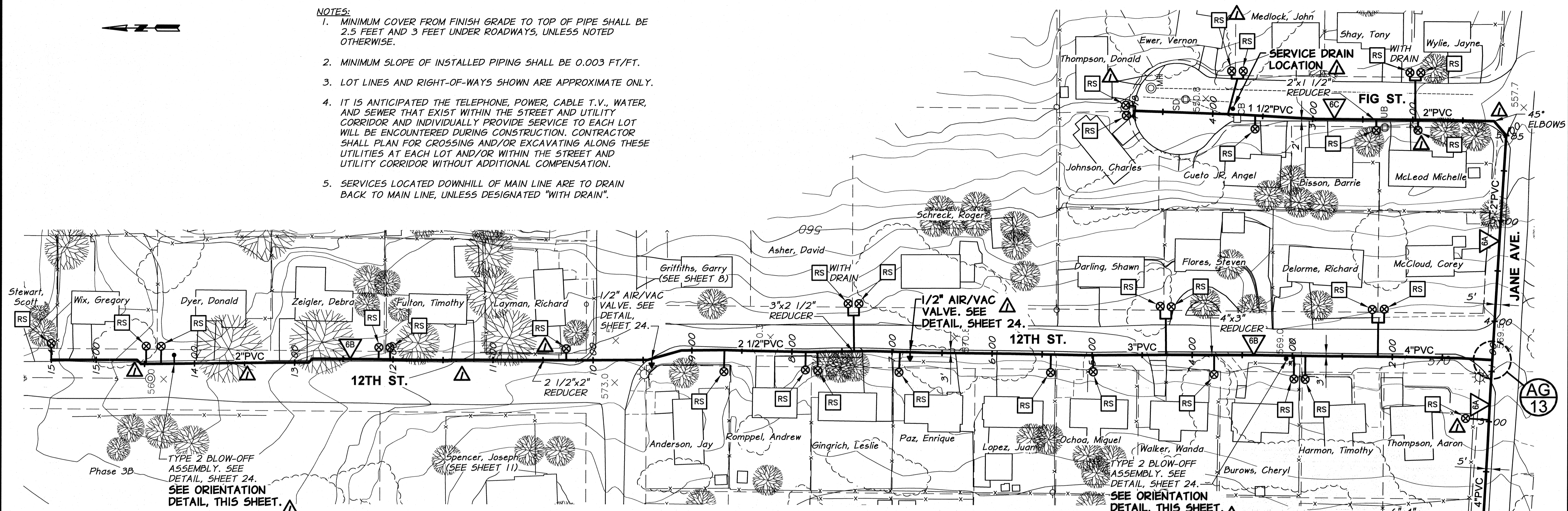

SURFACE RESTORATION SCHEDULE			
LINE	LOCATION (STA.)	DESCRIPTION	
6A	JANE AVENUE	1+00 TO 1+19	ASPHALT
		1+19 TO 3+37	HYDROSEED
		3+37 TO 4+00	ASPHALT
		4+00 TO 5+75	GRAVEL
		1+00 TO 1+28	ASPHALT
		1+28 TO 6+30	GRAVEL
		6+30 TO 6+35	CONCRETE
		6+35 TO 6+98	LANDSCAPE
		6+98 TO 7+30	ASPHALT
		7+30 TO 9+40	GRAVEL
6B	12TH STREET	9+40 TO 10+09	ASPHALT
		10+09 TO 10+33	LANDSCAPE
		10+33 TO 11+16	GRAVEL
		11+16 TO 11+49	ASPHALT
		11+49 TO 12+88	LANDSCAPE
		12+88 TO 13+24	ASPHALT
		13+24 TO 14+31	GRAVEL
		14+31 TO 14+46	ASPHALT
		14+46 TO 15+00	LANDSCAPE
		15+00 TO 15+49	GRAVEL
6C	FIG STREET	SERVICE CROSSINGS	ASPHALT AND GRAVEL
		1+00 TO 1+22	GRAVEL
		1+22 TO 4+82	ASPHALT
	SERVICE CROSSINGS	ASPHALT AND GRAVEL	

GRADE CONTROL SCHEDULE				
LINE	FROM STA.	TO STA.	CONTINUOUS SLOPE DIRECTION	
6A	JANE AVENUE	1+00	1+25	UPWARD
		1+25	5+75	DOWNWARD
6B	12TH STREET	1+00	3+05	*DOWNWARD
		3+05	6+80	*UPWARD
		6+80	7+40	DOWNWARD
		7+40	9+20	UPWARD
		9+20	14+30	DOWNWARD
6C	FIG STREET	1+00	4+82	DOWNWARD

\*NOTE: MAINTAIN SUFFICIENT MAIN LINE DEPTH TO DRAIN EAST SIDE SERVICES BACK TO MAIN LINE.

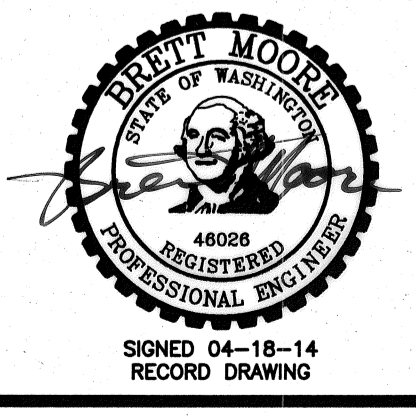

RECORD DRAWING		B.M.	4/14	SCALE IN FEET	
DESIGNED BY	H. MORRISON	BY		HORIZ. SCALE	1" = 50'
DRAWN BY	D. CHRISTMAN	DATE	2013	VERT. SCALE	
REVIEWED BY	B. MOORE	JOB NUMBER	1199-336	ACAD FILE	PNP-Phase3C.dwg
		DATE	2013		
					COPYRIGHT 2013 BY ANDERSON-PERRY & ASSOC., INC.

**RECORD DRAWINGS**  
APRIL 18, 2014  
These record drawings have been prepared, in part, on the basis of information compiled and furnished by others. They may contain some discrepancies and omissions, and do not necessarily represent "exact" field conditions. The Owner and the Engineer accept no responsibility for their accuracy.

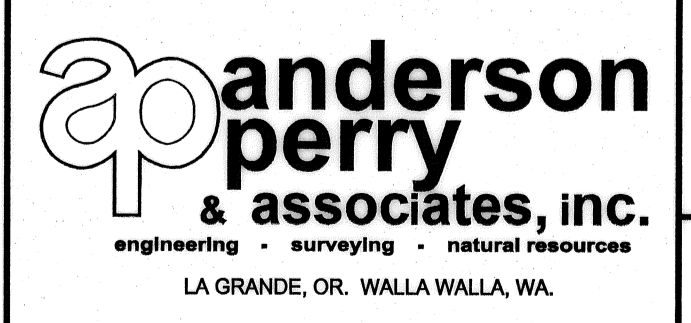

**BENTON IRRIGATION DISTRICT**  
IRRIGATION SYSTEM IMPROVEMENTS  
PHASE 3C  
**PIPING PLANS**  
JANE AVENUE, 12TH STREET, AND FIG STREET