

- WORK ITEMS**
- (A) EXISTING IRRIGATION LINE ALONG OR CROSSING ALIGNMENT. EXACT LOCATION UNKNOWN. REMOVE AND PLUG AS REQUIRED FOR NEW LINE INSTALLATION.
  - (B) EXISTING IRRIGATION CONTROL STRUCTURE TO BE REMOVED.
  - (C) EXISTING IRRIGATION LINE ALONG ALIGNMENT TO BE ABANDONED. REMOVE AND PLUG AS REQUIRED FOR NEW LINE INSTALLATION.

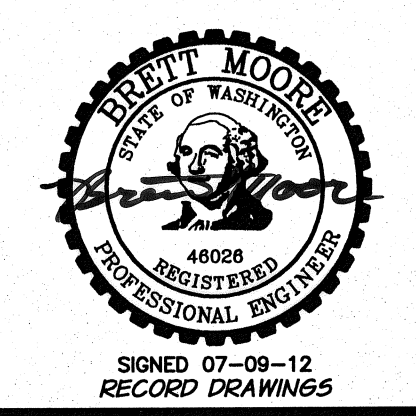

RECORD DRAWINGS		BY	B.M.	DATE	5/12
DESIGNED BY	R. HARRIS	XREFs: TB-BID.dwg			
DRAWN BY	E. ARNTZ	JOB NUMBER	1199-336	DATE	2011
REVIEWED BY	B. MOORE	ACAD FILE:	North_West_B.dwg	COPYRIGHT 2011 BY ANDERSON-PERRY & ASSOC., INC.	

**RECORD DRAWINGS**  
 These record drawings have been prepared, in part, on the basis of information compiled and furnished by others. They may contain some discrepancies and omissions, and do not necessarily represent "exact" field conditions. The Owner and the Engineer accept no responsibility for their accuracy.

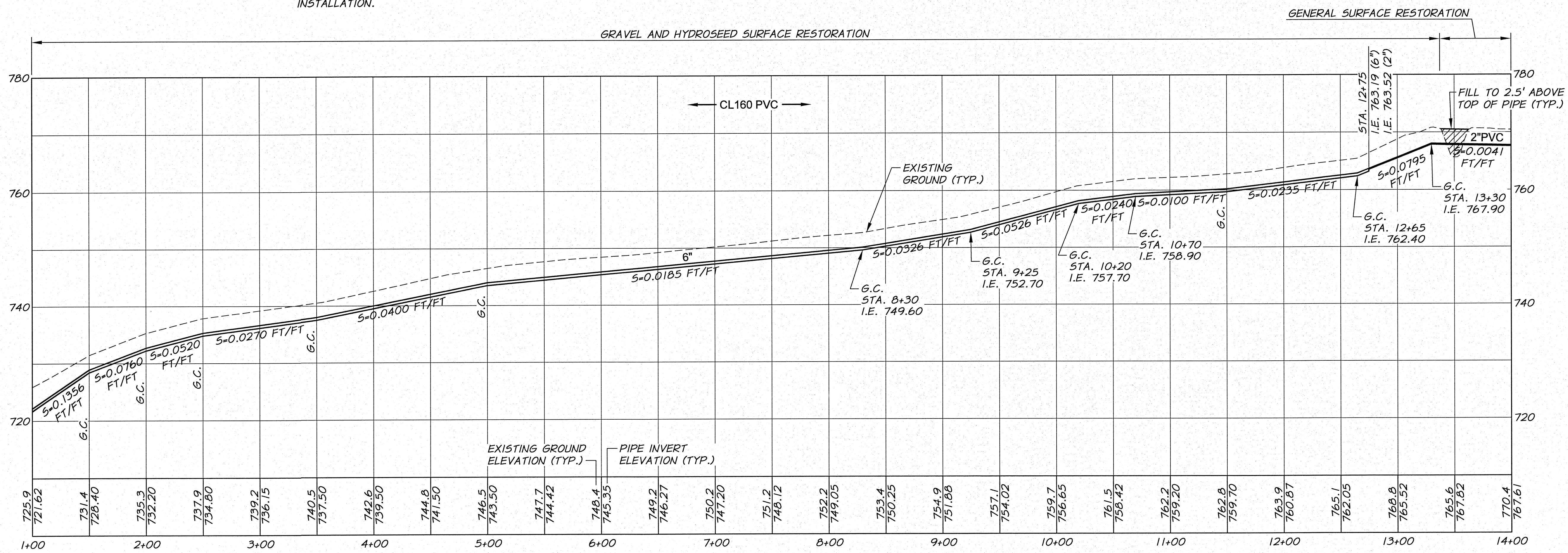
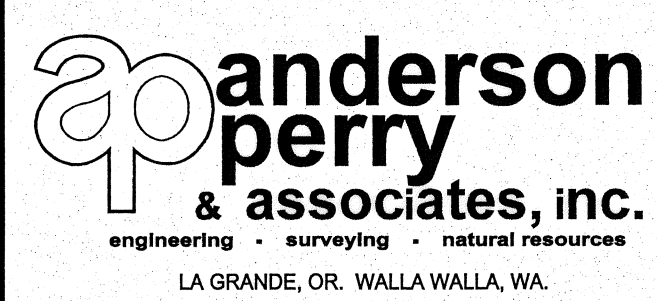

**BENTON IRRIGATION DISTRICT**  
 IRRIGATION SYSTEM IMPROVEMENTS  
 PHASE 2C  
 WEST ROSA ROAD PIPING  
 STA. 1+00 TO STA. 14+00