

**WORK ITEMS**

(A) EXISTING IRRIGATION LINE ALONG OR CROSSING ALIGNMENT. EXACT LOCATION UNKNOWN. REMOVE AND PLUG AS REQUIRED FOR NEW LINE INSTALLATION.

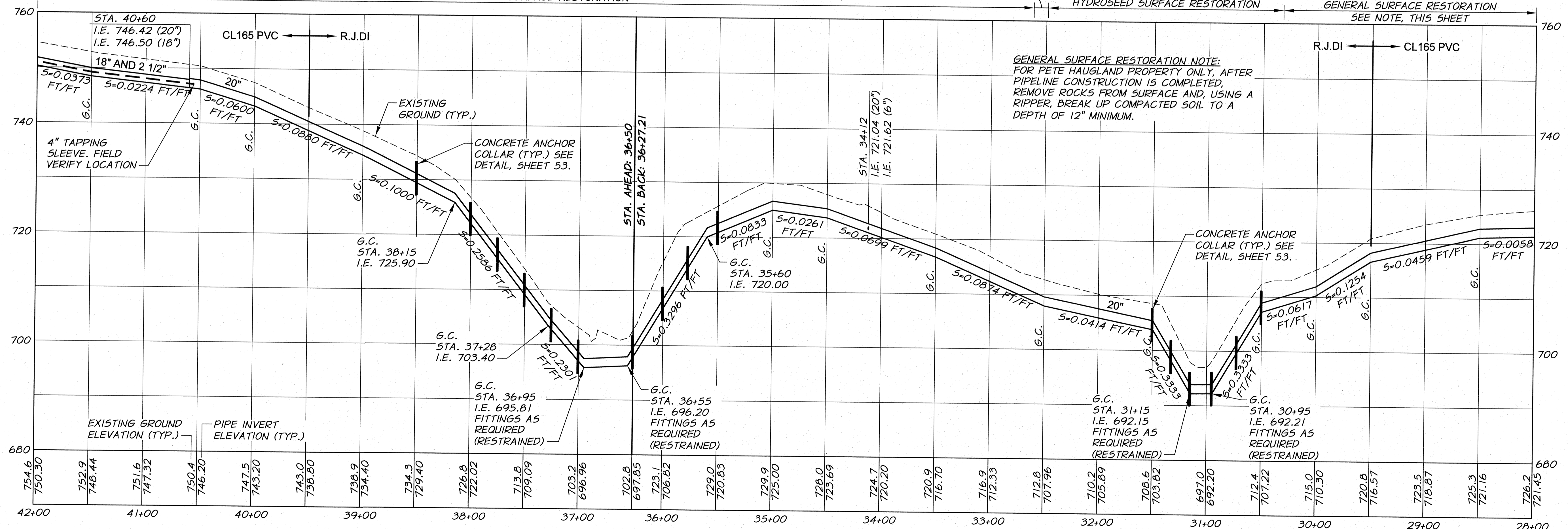

**GENERAL SURFACE RESTORATION NOTE:**  
 FOR PETE HAUGLAND PROPERTY ONLY, AFTER PIPELINE CONSTRUCTION IS COMPLETED, REMOVE ROCKS FROM SURFACE AND, USING A RIPPER, BREAK UP COMPACTED SOIL TO A DEPTH OF 12" MINIMUM.

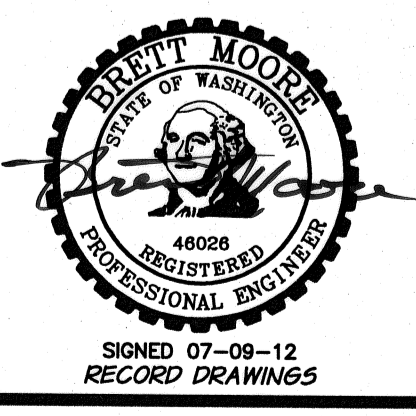

REVISION		BY	DATE
RECORD DRAWINGS		B.M.	5/12
DESIGNED BY	R. HARRIS	XREFS:	TB-BID.dwg
DRAWN BY	E. ARNTZ	JOB NUMBER	1199-336
REVIEWED BY	B. MOORE	ACAD FILE:	North_West_B.dwg

SCALE IN FEET	1" = 50'	SCALE IN FEET	1" = 10'
HORIZ. SCALE	1" = 50'	VERT. SCALE	1" = 10'
DATE	2011	DATE	2011
COPYRIGHT 2011 BY ANDERSON-PERRY & ASSOC., INC.			

**RECORD DRAWINGS**

These record drawings have been prepared, in part, on the basis of information compiled and furnished by others. They may contain some discrepancies and omissions, and do not necessarily represent "exact" field conditions. The Owner and the Engineer accept no responsibility for their accuracy.

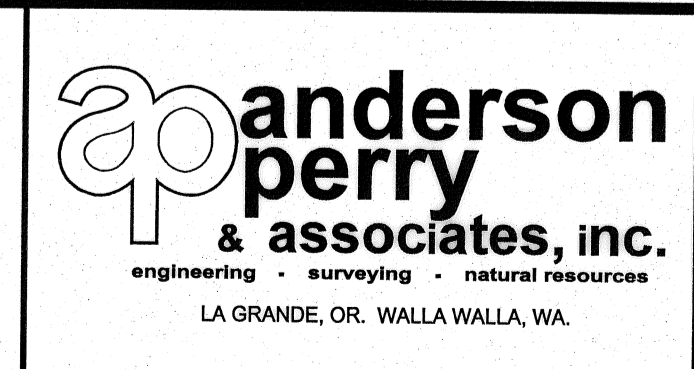

**BENTON IRRIGATION DISTRICT**  
 IRRIGATION SYSTEM IMPROVEMENTS  
 PHASE 2C

**EAST ROZA TO KNOX ROAD PIPING**  
 STA. 28+00 TO STA. 42+00

SHEET  
**6**