

WORK ITEMS

- (E) EXISTING IRRIGATION LINE ALONG OR CROSSING ALIGNMENT TO REMAIN. EXACT LOCATION UNKNOWN. POT HOLE PRIOR TO CONSTRUCTION. FOR MAIN LINE CROSSING CONFLICT, LOWER EXISTING LINE UNDER NEW LINE AS REQUIRED. SEE DETAIL, SHEET 51. FOR MAIN LINE PARALLEL LINE CONFLICT, ADJUST LOCATION OF NEW MAIN LINE AS REQUESTED BY THE ENGINEER TO PROVIDE CLEARANCE BETWEEN LINES. FOR NEW SERVICE LINE CROSSING EXISTING LINE, CONSTRUCT NEW SERVICE LINE UNDER THE EXISTING LINE, UNLESS OTHERWISE APPROVED BY THE ENGINEER. WORK TO BE INCIDENTAL TO SERVICE WORK. USE FITTINGS AS REQUIRED.

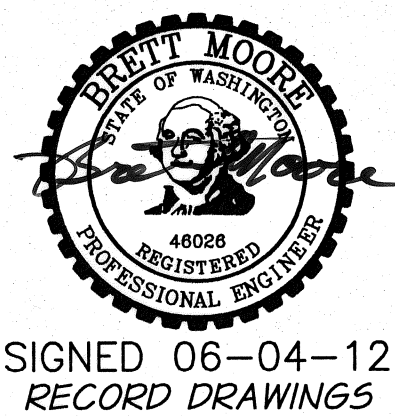
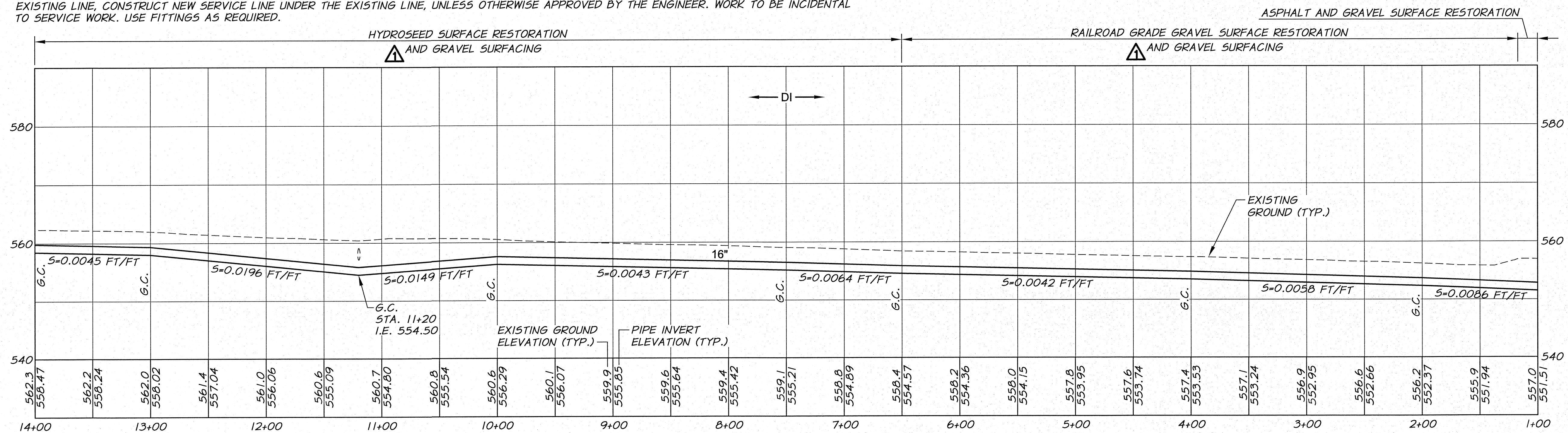

SIGNED 06-04-12
RECORD DRAWINGS

RECORD DRAWINGS		B.M.	5/12		
DESIGNED BY	R. HARRIS	DATE	5/12	HORIZ. SCALE	1"=50'
DRAWN BY	E. ARNTZ	DATE	2011	VERT. SCALE	1"=10'
REVIEWED BY	B. MOORE	ACAD FILE	West_Main_C.dwg	JOB NUMBER	1199-336
		XREFS: TB-BID.dwg		ACAD FILE	West_Main_C.dwg
COPYRIGHT 2011 BY ANDERSON-PERRY & ASSOC., INC.					

RECORD DRAWINGS
These record drawings have been prepared, in part, on the basis of information compiled and furnished by others. They may contain some discrepancies and omissions, and do not necessarily represent "exact" field conditions. The Owner and the Engineer accept no responsibility for their accuracy.

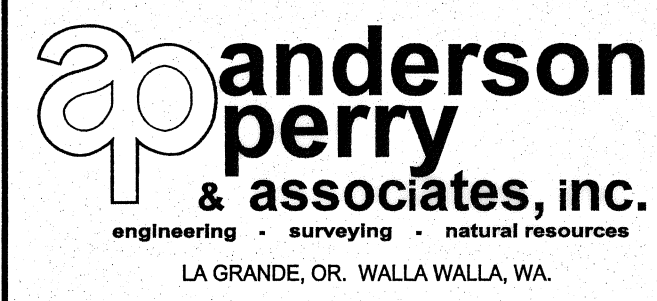

BENTON IRRIGATION DISTRICT
IRRIGATION SYSTEM IMPROVEMENTS
PHASE 2B
POWER PLANT TO O.I.E. HWY. PIPING
STA. 1+00 TO STA. 14+00