

NOTE:
 PRIOR TO CONSTRUCTION, THE CONTRACTOR SHALL COORDINATE WORK WITH THE SECURITY OFFICER, MR. TONY HARGROVES, OF THE CHANDLER POWER STATION. THE SECURITY OFFICER WILL ISSUE A PERMIT AND THE CONTRACTOR SHALL BE RESPONSIBLE FOR SIGNING THE CONSTRUCTION CREW IN AND OUT OF THE CHANDLER POWER STATION EACH DAY WORK IS PERFORMED. THE CONTRACTOR WILL BE ALLOWED TO INSTALL A LOCK ON THE GATE WHICH WILL ALLOW THE CREW ACCESS IN THE EVENT NO FEDERAL EMPLOYEE ARE ON SITE (WEEKENDS/HOLIDAYS) AND WILL BE EXPECTED TO KEEP THE GATE LOCKED WHEN NOT ON SITE.

CAUTION!
 ELECTRICAL SERVICE LINE. VERIFY LOCATION WITH BUREAU OF RECLAMATION (BOR). COORDINATE POTHOLING WITH BOR.

CAUTION!
 12,400V UNDERGROUND POWER LINE. VERIFY LOCATION WITH BUREAU OF RECLAMATION (BOR). COORDINATE POTHOLING WITH BOR.

RAILROAD GRADE GRAVEL AND HYDROSEED SURFACE RESTORATION

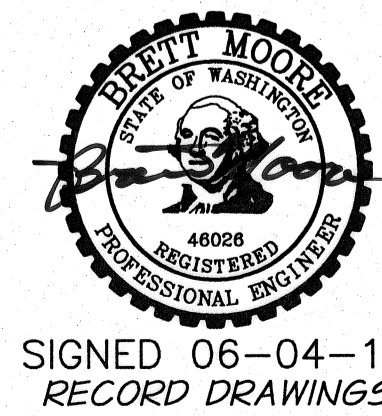
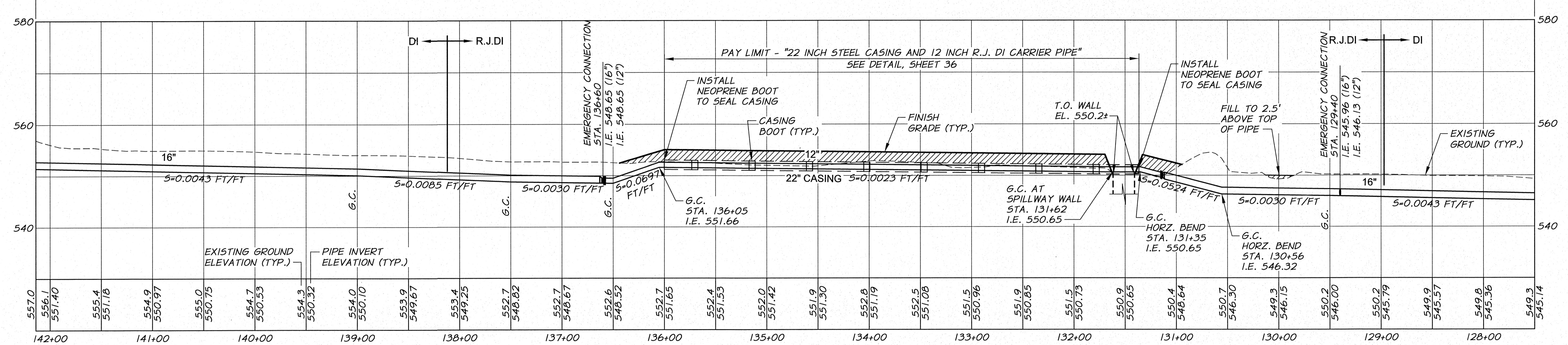

SIGNED 06-04-12
 RECORD DRAWINGS

RECORD DRAWINGS		B.M.	5/12
DESIGNED BY	R. HARRIS	XREFS:	TB-BID.dwg
DRAWN BY	D. CHRISTMAN		
REVIEWED BY	B. MOORE		

50 0 50 100 150	
HORZ. SCALE IN FEET	
10 0 10 20 30	
VERT. SCALE IN FEET	
HORZ. SCALE	1"=50'
VERT. SCALE	1"=10'
DESIGNED BY	R. HARRIS
DRAWN BY	D. CHRISTMAN
REVIEWED BY	B. MOORE
JOB NUMBER	1199-336
DATE	2011
ACAD FILE	West_Main_A.dwg
COPYRIGHT 2011 BY ANDERSON-PERRY & ASSOC., INC.	

RECORD DRAWINGS
 These record drawings have been prepared, in part, on the basis of information compiled and furnished by others. They may contain some discrepancies and omissions, and do not necessarily represent "exact" field conditions. The Owner and the Engineer accept no responsibility for their accuracy.

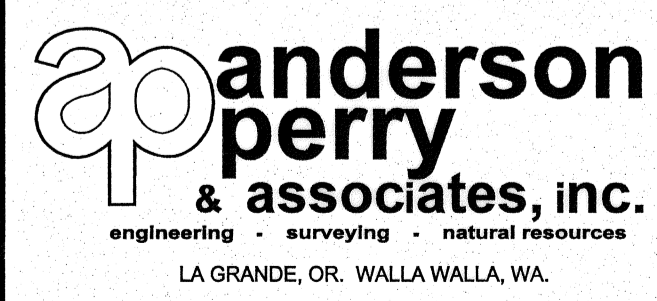

BENTON IRRIGATION DISTRICT
 IRRIGATION SYSTEM IMPROVEMENTS
 PHASE 2B
 CORRAL CREEK TO POWER PLANT PIPING
 STA. 127+50 TO STA. 142+13.91

SHEET
12