

WORK ITEMS

- (A) EXISTING IRRIGATION LINE ALONG OR CROSSING ALIGNMENT. EXACT LOCATION UNKNOWN. REMOVE AND PLUG AS REQUIRED FOR NEW LINE INSTALLATION.

NOTE:
 PROTECT ORCHARD LIMBS AS REQUIRED DURING CONSTRUCTION. EXPENSE FOR DAMAGE TO TREES WILL BE AT CONTRACTOR'S COST, AND NO COST TO THE OWNER.

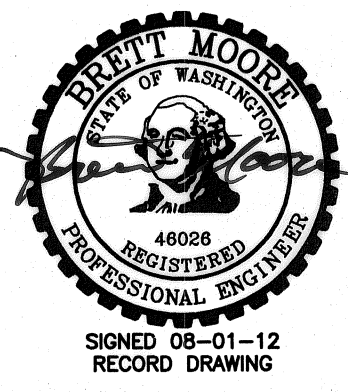
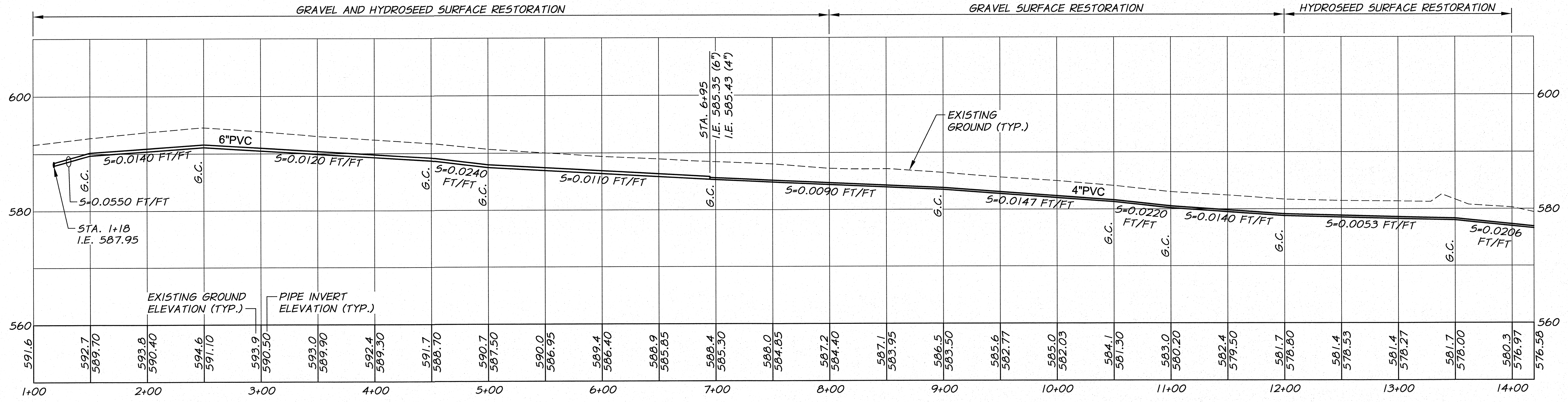

RECORD DRAWING		BY: E.H. DATE: 4/12	
DESIGNED BY: R. HARRIS	XREFS: TB-BID.dwg	JOB NUMBER: 1199-336	DATE: 2010
DRAWN BY: E. ARNTZ		ACAD FILE: East_A.dwg	
REVIEWED BY: J. HOLLOPETER		COPYRIGHT 2010 BY ANDERSON-PERRY & ASSOC., INC.	

RECORD DRAWINGS
 These record drawings have been prepared, in part, on the basis of information compiled and furnished by others. They may contain some discrepancies and omissions, and do not necessarily represent "exact" field conditions. The Owner and the Engineer accept no responsibility for their accuracy.

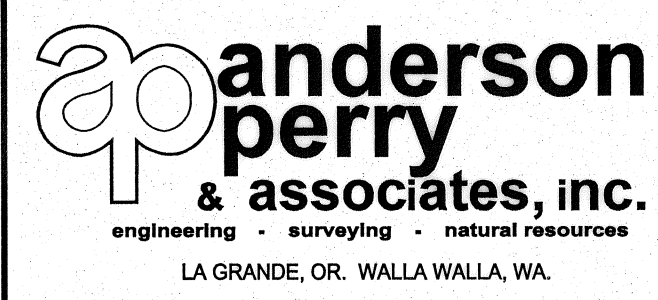

BENTON IRRIGATION DISTRICT
 IRRIGATION SYSTEM IMPROVEMENTS
 PHASE 2A
 EAST - HORNE TO MASON PIPING
 STA. 1+00 TO STA. 14+00

SHEET
29