

WORK ITEMS

- (A) EXISTING IRRIGATION LINE ALONG OR CROSSING ALIGNMENT. EXACT LOCATION UNKNOWN. REMOVE AND PLUG AS REQUIRED FOR NEW LINE INSTALLATION.

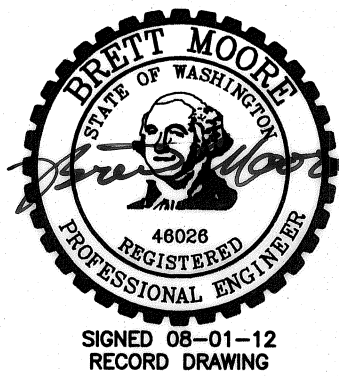
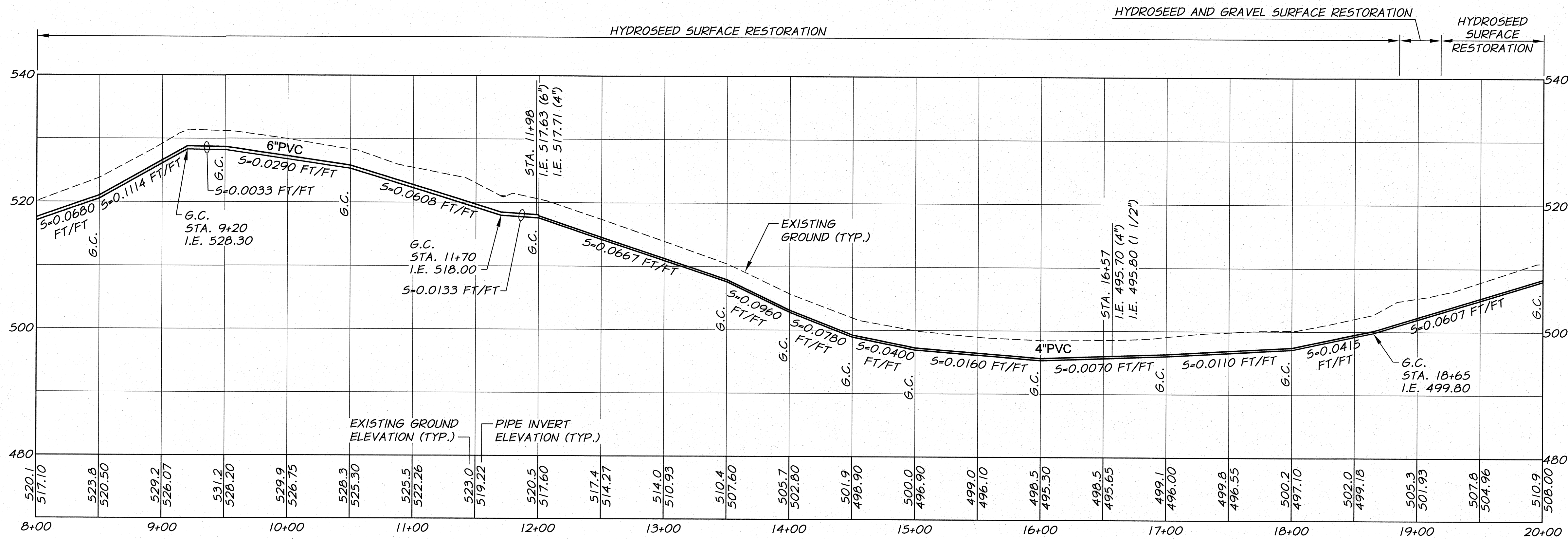

REVISION		BY	DATE
RECORD DRAWING		E.H.	4/12
DESIGNED BY	XREFS: TB-BID.dwg		
DRAWN BY	E. ARNTZ		
REVIEWED BY	J. HOLLOPETER		

HORIZ. SCALE	1" = 50'
VERT. SCALE	1" = 10'
JOB NUMBER	1199-336
DATE	2010
ACAD FILE	North_East_B.dwg
COPYRIGHT 2010 BY ANDERSON-PERRY & ASSOC., INC.	

RECORD DRAWINGS

These record drawings have been prepared, in part, on the basis of information compiled and furnished by others. They may contain some discrepancies and omissions, and do not necessarily represent "exact" field conditions. The Owner and the Engineer accept no responsibility for their accuracy.

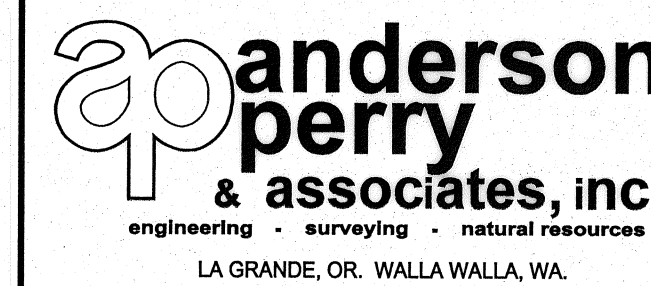

**BENTON IRRIGATION DISTRICT
IRRIGATION SYSTEM IMPROVEMENTS
PHASE 2A**

**NORTH EAST - HORNE TO HIGHLAND EXT. PIPING
STA. 8+00 TO STA. 20+00**

SHEET

20

ARCHIVED